

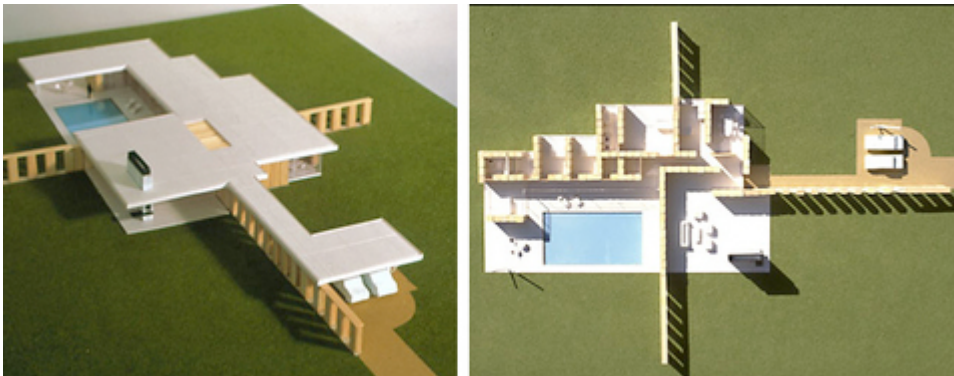

November 03, 2006

Unveiling of the Ban and Maltz House



The Houses at Sagaponac is a development launched by the late Harry J. Brown and Richard Meier, featuring 34 summer homes designed by internationally recognized architects on a 65-acre site. The latest one to open was designed by Shigeru Ban and Dean Maltz, and DWR not only furnished the space but will be hosting the unveiling. Based on an unbuilt Ludwig Mies Van der Rohe brick country house, the Ban and Maltz House also includes artwork curated by Silas Marder Gallery.

Saturday, November 11, 5–7pm

21 Forest Crossing

Houses at Sagaponac

Sagaponack NY 11962

Posted by Erin Brown at 10:08:58 AM in Architecture

"A house was rarely visible, we never saw one from the beach, and the solitude was that of the ocean and the desert combined."

– HENRY DAVID THOREAU

